

# WATERSHIELD ULTRA HIGH IMPACT XTERIOR INSULATION SYSTEM

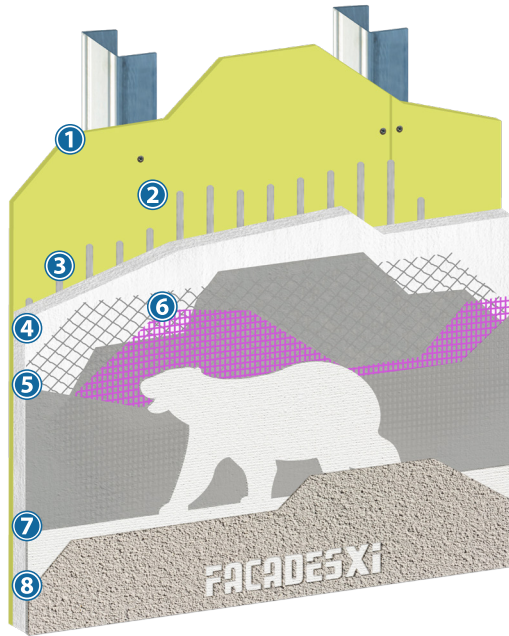

## SYSTEM DESCRIPTION

WaterShield Xterior Insulation System is a tested, warranted, code compliant and engineered Exterior Insulation Finish System with monolithic water and air barrier coating and accessory materials, internal drainage, continuous Xterior Insulation, and countless integrally colored finishing options. Xterior insulation gives this system the ability to meet any energy code requirements with the ease of one system and the design flexibility and lightweight system for any designers vision. With the addition of 20 oz mesh or Ultra Impact Base Coat / 11oz mesh, the system can provide the highest impact resistance.

### Optional Advantages Upgrades

- XPS Xterior Insulation for higher R Value per inch
- Consistency Enhancement: Xi-Alkali Resistant Primer

## COMPONENTS

- ① **Substrate**
  - ASTM C1177 glass mat faced sheathing
  - ASTM C1325 Type A Exterior cement-board
  - Exposure I or exterior plywood sheathing (grade C-D or better)
  - Exposure I OSB
  - Poured concrete/unit masonry/brick
- ② **WaterShield Water and Air Barrier Assembly**
  - WaterShield Water & Air Barrier
  - WaterShield Flashing Tape
  - WaterShield Joint Mesh
  - FXI FlashFill
- ③ **Means of Drainage / Insulation Board Attachment**
  - Vertical Ribbons of Adhesive
- ④ **Continuous Insulation**
  - Expanded Polystyrene
- ⑤ **Base Coat**
  - Xi-Acrylic Base Coat
  - Xi-Dry Acrylic Base Coat
  - Xi-Ultra Impact Liteweight Base coat (can be used with Xi-Mesh 11 for Ultra Impact)
- ⑥ **Reinforcing Mesh**
  - Xi-Mesh11 (Only with Ultra Impact Base Coat)
  - BearMat 15/Xi-Mesh
  - BearMat 20/Xi-Mesh
- ⑦ **Primer (Optional per specification) – for decreased efflorescence and highest finish coat aesthetic performance.**
  - Xi-Alkali Resistant Primer
- ⑧ **Finish Coat – Integrally colored and textured. Unlimited color selection, dirt pick up resistant**
  - Xi-Textured Acrylic Finish

*Consult system specifications for exact component options.*

## USES

Exterior, new, retrofit, residential, multi-family, commercial, panelized, institutional, hotels, hospitals, retail centers, schools, condominiums, and government facilities. High Impact Systems Available.

## COMPLIANCE / APPROVALS

WaterShield Xterior Insulation System is installed as a code compliant Exterior Insulation and Finish System in conformance with

- International Building Code
- International Residential Code
- ASTM E2568
- ASTM E2570
- ASTM E2273
- ICC Acceptance Criteria 235
- ICC Acceptance Criteria 212
- ASHRAE 90.1
- NFPA 268
- NFPA 285

## ADVANTAGES

- WaterShield provides an enhanced water and air barrier for envelope protection
- Continuous Insulation outperforms cavity insulation and gives greater energy savings
- Impact resistant systems available
- Mold and mildew resistant finishes
- Unlimited color and design aesthetics
- EPS shapes for architectural details
- Labor costs and time savings
- Single source warranty
- Lower Cladding Weight for decreased structural requirements
- Non-combustible and Fire resistant assemblies are available

## DESIGN CONSIDERATIONS

- All products must be installed in accordance with current Evaluation Report.
- Maximum allowable deflection  $L/240$ .
- The design wind load shall be determined by the Evaluation Report or per the structural engineer.
- Wood-based sheathing should be gapped 1/8-inch.
- All penetrations shall be properly treated, flashed and/or sealed using approved installation designed for water drainage to the exterior of the wall.
- Expansion joints are per project design. See Specifications and details for expansion joint locations.
- Sealant joints shall be detailed and installed per sealant manufacturer's recommendations.

## LIMITATIONS

- Ambient and surface temperature must remain above 40°F (4°C) during and for 24-hours after set has occurred.
- Protect applied product from inclement weather until dry.
- Fire Rated and Non-combustible assemblies must be per the current Evaluation Report
- For increase Impact resistance: Utilize BearMats in conjunction with Standard Mesh
- Select colors with light reflectance value (LRV) greater than 20. Under extreme conditions, dark colors may increase the temperature of the polystyrene boards to greater than its allowable service temperature limit of 160°F (71°C).
- System must terminate above grade per the current Evaluation Report.
- No additives are permitted to any components unless specifically approved by FXI.
- Follow the application instructions for each component.
- Use only on surfaces that are sound, dry, clean, unpainted, and free from any residue that may affect the ability of the FACADESXi Products to bond.
- Watershield should not be left exposed more than 6 months.
- For use on vertical above grade walls only.
- Maintenance Required: periodic cleaning, repair of cracks and impact damage if they occur, recoating to enhance appearance of weathered finish.

This system bulletin is not to be used as an application guide. See System specifications, details, and product datasheets for specific installation information.

Watershield Ultra High Impact Exterior Insulation System SB 07/14/2025